

Tool Series 375: HSC Carbide End Mills for Soft Materials - Long Length

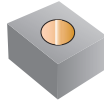

Tolerance (Uncoated):	
D1=D2:	h5
D1<D2:	h6
D2:	h5

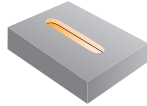
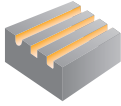
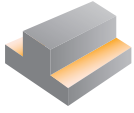
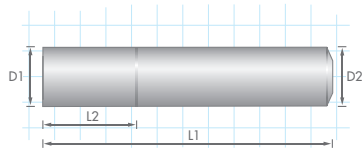
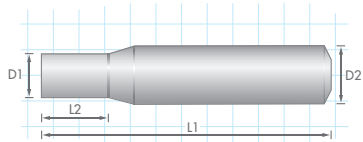

Uncoated Tool Number	Coated Tool Number	D1	D2	L1	L2	Z
375-2030	375-2030-P	3	6	75	25	2
375-2040	375-2040-P	4	6	75	25	2
375-2050	375-2050-P	5	6	75	25	2
375-2060	375-2060-P	6	6	75	25	2
375-3060	375-3060-P	6	6	75	25	3
375-3080	375-3080-P	8	8	75	30	3
375-3100	375-3100-P	10	10	100	38	3
375-3120	375-3120-P	12	12	100	50	3
375-3160	375-3160-P	16	16	150	75	3
375-3200	375-3200-P	20	20	150	75	3

